

MATERIAL

Contact: Phosphor Bronze Tin Plated over 50u" Nickel.
 Insulator: PPS&40% Glass Fiber(UL94V-0)

SPECIFICATION

Current Rating: 1A
 Voltage Rating: 125VAC
 Dielectric Strength: 600VAC/RMS for 1 minute
 Contact Resistance: 20mΩ max.
 Insulation Resistance: 1000MΩ at 500VDC
 Operating Temperature: -40°C+105°C

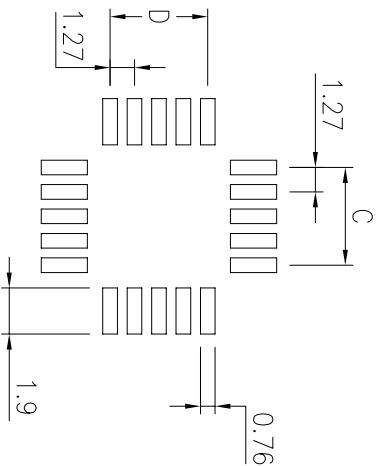
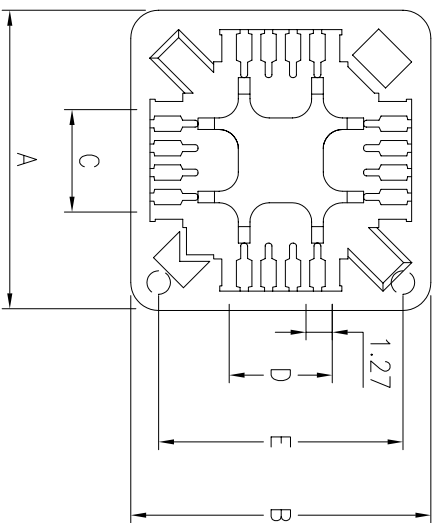

P.C.B. LAYOUT

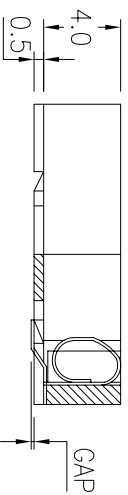

PLCC-SMT

CKT	A	B	C	D	E
20	15.24	15.24	5.08	5.08	16.70
28	17.78	17.78	7.62	7.62	20.30
52	25.40	25.40	15.24	15.24	31.10
68	30.84	30.84	20.32	20.32	27.94
84	35.92	35.92	25.40	25.40	33.02

HOW TO ORDER

PLCCX - XX - SMT

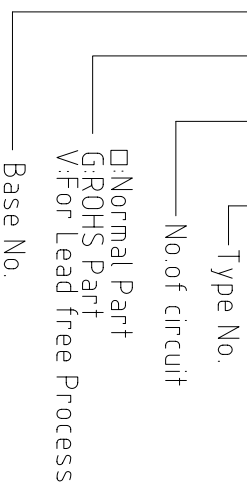

LONG CHU ELECTRONICS CO. LTD
LCU 龍竹企業股份有限公司

DESCRIPTION:

PLCC SOCKET SMD TYPE

REV.	NEW RELEASE	REV. RECORD	DATE	MATERIAL SEE LIST	DR. KELLY	UNIT mm	RE. APP.	CHK.
A			4/29/04*					
REV.								

GENERAL TOLERANCE	SIZE	P/N
0. ±0.50	A4	PLCC-SMT SERIES
0.0 ±0.30	SCALE 1/1	REV. A
0.00 ±0.20		SHEET NO.